

G55JCS14XX Series Stainless Steel

31" Stainless steel folding grab bar. 1.25" diameter, 1.2mm wall thickness, 304 stainless steel.

Mounting hardware not supplied.

Product Data

Overall Dimensions (Inch.)	41-15/16 x 31-1/2 x 8-11/16
Net Weight (lbs.)	4.45

Packaging Details

Package	Cardboard package
Package dimensions (Inch.)	33-5/16 x 10-5/8 x 5-1/8
Weight with Packaging (lbs.)	5.51

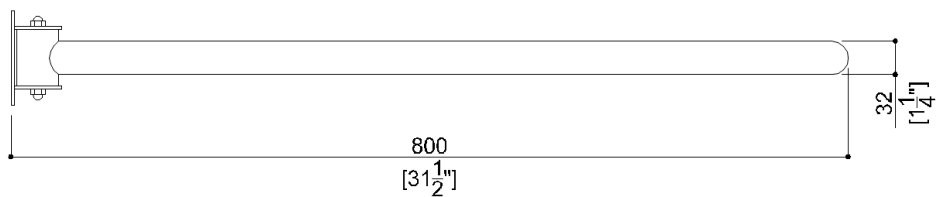
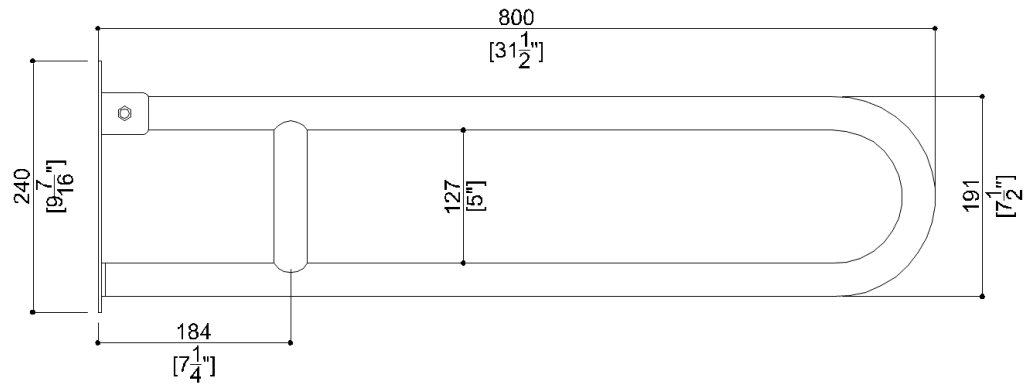
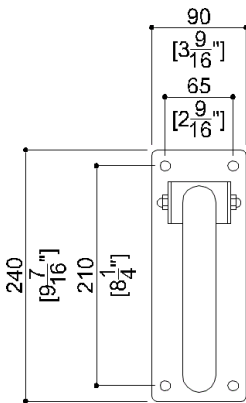
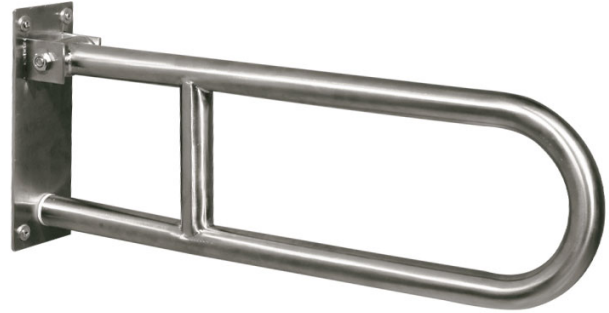

G55JCS14XX Series Stainless Steel

AISI304 stainless steel fixing plate

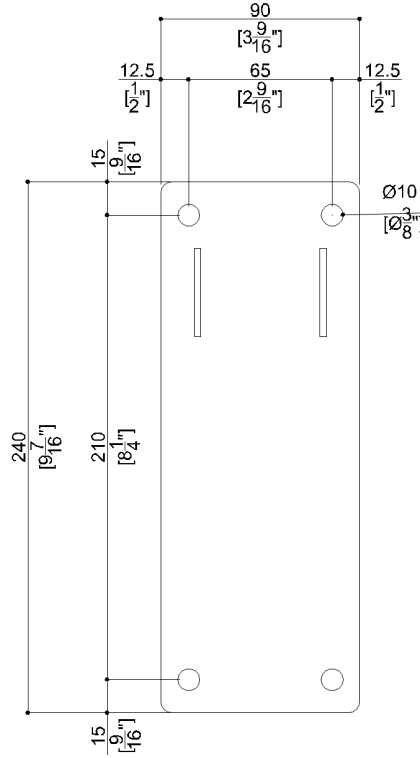

Available Finishes (xx)

- N1  Satin

Load Capacity

Vertical	265 lbs.	Horizontal	88 lbs.
----------	----------	------------	---------

Warning

Before installation and use, read the installation and use instructions in their entirety. If questions arise please contact Ponte Giulio company.

Cleaning

Product can be cleaned with a cloth and warm soapy water. Non abrasive, solvent free cleaners can also be used.

Warranty

Please visit www.pontegiulio.com for complete warranty details.

Materials and finishes

Stainless Steel	Satin
-----------------	-------