

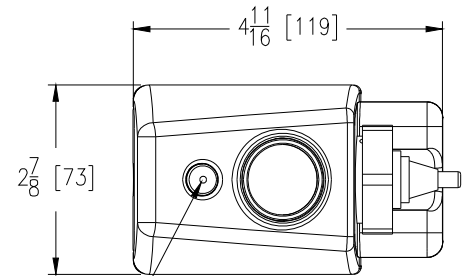

# ZERK-CCP

Sensor Operated Battery Powered Retrofit Kit for Water Closet and Urinal Flush Valves

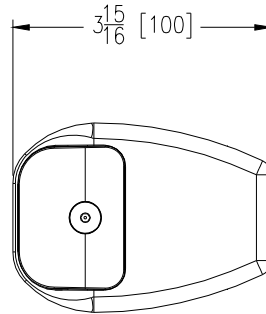

OVERRIDE BUTTON



## Accessories

- CB Cambridge Brass Retro Fit
- GM Sloan/Gem Retro Fit
- HMK Highmount Adapter
- LY Delaney Valve Retro Fit
- MC Metroflush/Crown Valve Retro Fit
- \_\_\_\_\_ Other

## ENGINEERING SPECIFICATIONS

AquaSense® E-Z Flush Unit designed to provide automatic flushing for urinals and/or water closet flush valves.

- Impact Resistant Chrome Plated Housing
- Sensor
  - Infrared
  - User in-view L.E.D
  - Low battery indicator light
  - 24 hour auto-flush setting
  - 3 second delay flush
- Override Button
- 6 VDC Motor Actuator
  - Ultra energy efficient electronics
  - 4 "C" size batteries (Included)
- ADA Compliant
- Included tools
  - Wrench for installation
  - Allen key for battery compartment

Architectural/Engineering Approval

The information contained in this document is subject to change without notice.  
Please contact Zurn for most up to date information.

ZURN INDUSTRIES, LLC. ♦ COMMERCIAL BRASS OPERATION  
 5900 ELWIN BUCHANAN DRIVE ♦ SANFORD NC 27330  
 PHONE: 1-800-997-3876 ♦ FAX: 919-775-3541  
 WWW.ZURN.COM  
 IN CANADA: ZURN INDUSTRIES LIMITED  
 3544 NASHUA DRIVE ♦ MISSISSAUGA, ONTARIO L4V1L2  
 PHONE: 905-405-8272 FAX: 905-405-1292

AquaSense® is a registered trademark of Zurn Industries, LLC.

Rev. D  
Dwg. No. 63484

Date: 3/15/12  
Product No. ZERK-CCP