

# AUTOMATIC LAVATORY-MOUNTED FOAM SOAP DISPENSER

**B-8263  
B-8263.18**

**Specify Model Required:**

- ☐ Model B-8263 Automatic Lavatory-Mounted Soap Dispenser  
☐ Model B-8263.18 Starter Kit. Includes B-8263 Soap Dispenser, an 800ml soap refill, 4 Alkaline D Cell Batteries

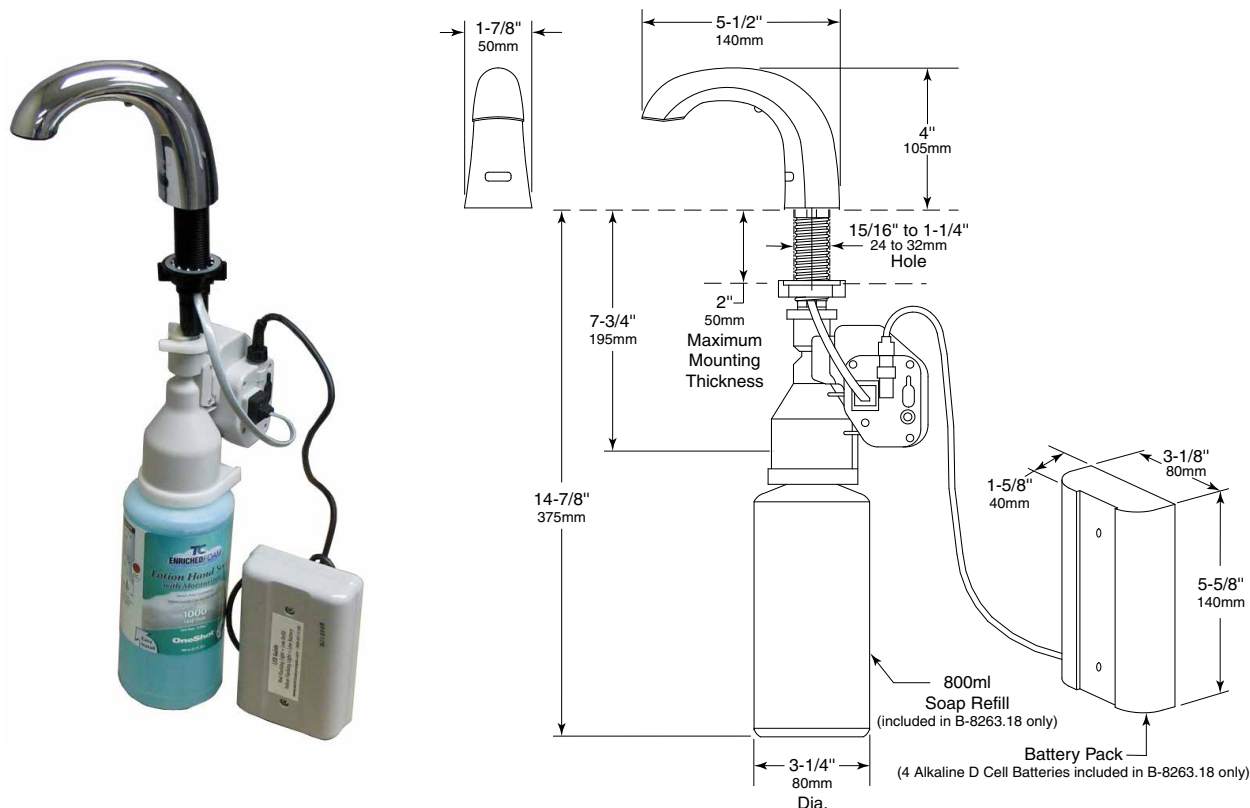

**MATERIALS:**

**Spout Cover Assembly** — Bright Polished chrome plated plastic with LED light indicators. Red blinking LED indicates soap level is low, Yellow blinking LED indicates battery life is low. Equipped with integral plastic shank.

**Motor Assembly** — Water resistant, plastic construction, fits onto bottom of shank and top of soap refill.

**Battery Pack** — Water resistant, plastic material, holds 4 Alkaline "D" Cell Batteries. Batteries are included in Model B-8263.18 Starter Kit only. Average battery life is 90,000 cycles or 2 years.

**Soap Refill** — OneShot® Soap Refill. Translucent, shatter-resistant polyethylene bottle. Includes new supply tube and pump mechanism in each refill. Soap refill available in 27-fl oz (800ml) and 54-fl oz (1600ml) capacities. One 27-fl oz (800ml) bottle of Hand Soap with Moisturizers is included in Model B-8263.18 only. OneShot® is a registered trademark of Rubbermaid Commercial Products.

**Optional Spacer** — Plastic spacer is included for mounting dispenser when sink rim is 3/4" (19mm) high or greater.

**OPERATION:**

Place hand under soap spout for approximately 2 seconds. Spout will dispense controlled amount (0.8ml) of Hand Soap with Moisturizers or Free 'n Clean Soap. 27-fl oz (800ml) soap refill provides 1000 hand washes, the 54 fl oz (1600ml) soap refill provides 2000 hand washes. Motor assembly is preset for 27-fl oz (800ml) soap refill (if 54-fl oz (1600ml) is used, a switch under the rubber plug next to red reset button must be moved to 2K). Once a new soap refill is connected, pressing the red reset button automatically resets the low soap indicator LED and primes the new soap refill.

continued . . .

## INSTALLATION:

Unit is designed for installation in 15/16" to 1-1/4" (24 to 32mm) diameter hole in porcelain-enameled steel, cast iron or vitreous-china lavatories, as well as in countertops adjacent to lavatories. Unit may be mounted in unused faucet hole or through special hole requisitioned when lavatory is ordered from manufacturer (specify punching location). Shank accommodates maximum 2" (50mm) mounting thickness. Clearance required for soap refill bottle and motor housing is 5" (125mm) for the 27-fl oz (800ml) soap refill and 5-1/2" (140mm) diameter for 54-fl oz (1600ml) soap refill and 11-5/8" (295mm) minimum depth for height of 27-fl oz of soap refill bottle and motor housing and 13-5/8" (345mm) minimum depth for height of 54-fl oz. (1600ml) soap refill bottle and motor housing. Place 4 "D" Cell Batteries (included in Model B-8263.18 only) into battery pack. An optional single 6V AC adapter to replace the battery pack is available, order Part No. 826-20.

	<b>27-fl oz. 800ml</b>	<b>54-fl oz. 1600ml</b>
<b>Diameter of Bottle and Motor</b>	5" 125mm	5-1/2" 140mm
<b>Clearance Below Counter</b>	11-5/8" 295mm	13-5/8" 345mm

## SPECIFICATION:

Automatic Lavatory-Mounted Foam Soap Dispenser shall dispense controlled amount (0.8ml) of Hand Soap with Moisturizers or Free 'n Clean Soap or Hand Soap. Spout cover assembly to be Bright Polished chrome plated plastic. Meets accessible design standards. Unit shall have blinking LED indicators to show low soap level and low battery life. Shank shall accommodate mounting thicknesses up to 2" (50mm). Translucent, shatter-resistant polyethylene soap refill (800ml soap refill included in model B-8263.18 only) shall have capacities of 27-fl oz (800ml) or 54-fl oz (1600ml).

**Automatic Lavatory-Mounted Foam Soap Dispenser shall be Model B-8263 of Bobrick Washroom Equipment, Inc., Clifton Park, New York; Jackson, Tennessee; Los Angeles, California; Bobrick Washroom Equipment Company, Scarborough, Ontario; Bobrick Washroom Equipment Pty. Ltd., Australia; and Bobrick Washroom Equipment Limited, United Kingdom.**