

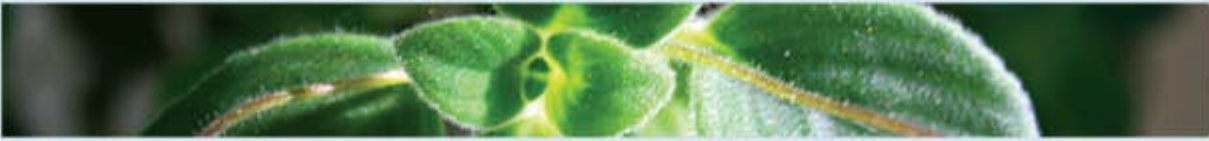

**PALMER  
FIXTURE**

*Since 1907*

# CONTENTS



COVER	
CONTENTS.....	2
INTRODUCTION.....	2
PAPER VS. HAND DRYERS.....	3
BENEFITS OF HAND DRYERS.....	3
ISTORM.....	4-5
BLUSTORM.....	6-7
BACK COVER	



## PALMER FIXTURE HISTORY

For over 100 years, Palmer Fixture has been committed to providing the most competitive value-added systems available. Palmer Fixture offers a variety of items from the old school metal crank dispensers to our high-tech automatic touchless dispensers and high speed hand dryers. We are constantly expanding our product lines and are looking for more ways to satisfy our customers. Most of our products are made in the USA and are subject to strict quality control processes. Through extensive research and development, Palmer Fixture Company has maintained a world wide reputation for product excellence since 1907.

Palmer Fixture can provide you with a number of solutions based on our product offerings and expertise. We continue to be a leader in our industry and are continuously working on new innovative products to make your life cleaner, greener and more hygienic.



# THE BENEFITS OF HAND DRYERS

## ENVIRONMENT

- Recycled paper towels create millions of cubic feet of waste in landfills each year.
- The production of paper is almost twice as energy intensive as the use of hand dryers. It also creates more greenhouse gases. This doesn't even factor in the pollution produced by transporting paper goods.
- By switching from paper towels to hand dryers a small school could save 24 trees, 4.2 Cubic meters of landfill, over 28,000 gallons of water, and 43.80 CO2 emissions per year.
- Used paper towels cannot be recycled, only thrown away.

1 Case = 6 Rolls of Paper Towels



=



=



1 Case = 27 Bags of Paper Waste

## SAVINGS

- The cost of one person drying his/her hands with paper towels is equivalent to approximately 100 people drying their hands with the EcoStorm high speed hand dryer.

## HYGIENE

- When testing was done to see if hand dryers contribute to the spread of disease, "Matthews & Newsom showed neither paper towels nor hot air dryers contributed significantly to environmental contamination when drying their hands." (1)
- "There is no bacteriological reason to exclude hand dryers when compared to paper towels," in the results attained by Meers & Leong. (3)
- A study done at the Mayo Clinic recorded their results in the journal Mayo Clinic Proceedings that there are "no statistically significant differences," referring to hand drying methods between paper towels and hand dryers. (2)

**BLU**STORM  
Hand Dryer



=



=



1. Matthews, J.A. & Newsom S.W.B (1987). Hot air electric hand dryers compared with paper towels for potential spread of airborne bacteria. Journal of Hospital Infection 9, 85-88.

2. Mayo Clinic Proceedings. (2000). 75: 706-708

3. Meers, P.D., & Leong, K.Y. (1989). Hot-air hand dryers. J.Hosp. Infect., 14, 169-171



MASTERY OF FORM AND FUNCTION  
DESIGNED TO ENDURE



MODEL NO.	COVER MATERIAL	FINISH	MOUNTING OPTIONS	VOLTS	WATTS	AMPS	WEIGHT
HD0980-17	ABS PLASTIC	WHITE	SURFACE	110/120	1200	9.2-10	24 LBS.
HD0981-17	ABS PLASTIC	WHITE	SURFACE	208/220	1200	4.3-5	24 LBS.
HD0982-17	ABS PLASTIC	WHITE	SURFACE	277	1200	4.6-5	24 LBS.

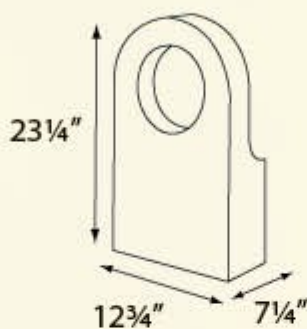

FRONT VIEW

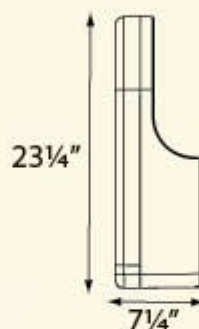

SIDE VIEW

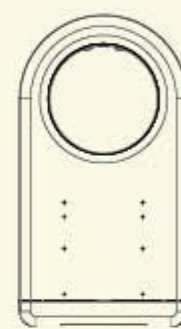

BACK MOUNTING VIEW



MODEL NO.	COVER MATERIAL	FINISH	MOUNTING OPTIONS	VOLTS	WATTS	AMPS	WEIGHT
HD0980-16	ABS PLASTIC	BLACK	SURFACE	110/120	1200	9.2-10	24 LBS.
HD0981-16	ABS PLASTIC	BLACK	SURFACE	208/220	1200	4.3-5	24 LBS.
HD0982-16	ABS PLASTIC	BLACK	SURFACE	277	1200	4.6-5	24 LBS.

MODEL NO.	COVER MATERIAL	FINISH	MOUNTING OPTIONS	VOLTS	WATTS	AMPS	WEIGHT
HD0980-08	ABS PLASTIC	PLATINUM	SURFACE	110/120	1200	9.2-10	24 LBS.
HD0981-08	ABS PLASTIC	PLATINUM	SURFACE	208/220	1200	4.3-5	24 LBS.
HD0982-08	ABS PLASTIC	PLATINUM	SURFACE	277	1200	4.6-5	24 LBS.



**TECHNICAL SPECIFICATIONS:**

ACTIVATION: AUTOMATIC ON/OFF, INFRARED SENSOR  
 DRY TIME: 10 SECONDS  
 MOTOR TYPE: 1 HP BRUSH TYPE, DUAL BALL BEARINGS  
 RPM: ADJUSTABLE - 11,000-20,000 RPM  
 RATED POWER: 1200W (750W WITH HEATER OFF)

ISOLATION: CLASS 1  
 OPERATING AIRFLOW: 19,869 LFM, ADJUSTABLE  
 DECIBEL LEVEL: 66.1 DB  
 DRIP PROOF: IP23  
 5 YEAR LIMITED WARRANTY





# storm

Hand Dryer



**Dual color LED sensor**  
allows user to maximize the  
dryer's efficiency

**Antibacterial coating**  
inhibits and reduces the ability for  
microorganisms to grow, lasting the  
lifetime of the dryer

**Innovative air outlets**  
aim down and back to protect  
users from unwanted water  
splash-back

**Hygienic space opening**  
allows hands to be rubbed together  
without touching the sides of the  
dryer

**Innovative absorbent  
ceramic plate**  
captures water runoff and  
prevents the problem of  
water overflow, keeping  
floors dry and safe



**Adjustable air speed**  
for customizable settings that  
will maximize the hand dryer's  
efficiency for all environments

**On/Off switch for heater**  
so air temperature is  
appropriate for all climates

**Removable drip tray**  
optional for high volume areas



**Super 3-layer filter**  
(HEPA, carbon, and anti-microbial)  
eliminates over 99% of airborne bacteria  
Filter: SP098099-002



**Backsplash Kit**  
captures water and prevents the  
wall from unsightly water marks  
and damage  
Backsplash Kit: SP098099-050  
Plate Only: SP098099-051





**TECHNICAL SPECIFICATIONS:**

ACTIVATION: AUTOMATIC ON/OFF

DRY TIME: 10-15 SECONDS

MOTOR TYPE: 15/16HP, 700W BRUSH TYPE, DUAL BALL BEARINGS

HEATER THERMAL PROTECTION: THERMAL CUT OFF AT 185°F (85°C)

DRIP PROOF: 1PX1

ISOLATION: CLASS I

AIR OUTPUT TEMPERATURE: 115°F (45°C), AMBIENT TEMP. 68°F (20°C)

OPERATING AIR FLOW: 19,680 LFM, ADJUSTABLE

RPM: 18,000

HEATING ELEMENT: 900W

5 YEAR WARRANTY

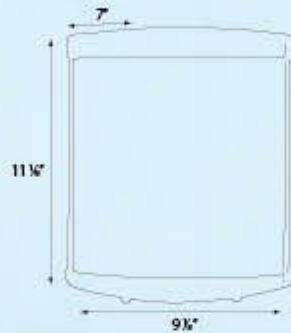

FRONT VIEW



SIDE VIEW

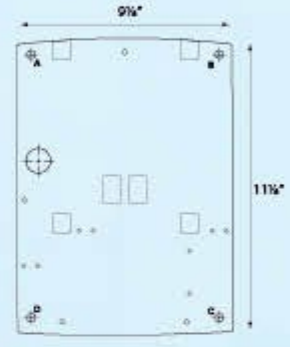

BACK MOUNTING VIEW

MODEL NO.	COVER MATERIAL	FINISH	MOUNTING OPTIONS	VOLTS	WATTS	AMPS	WEIGHT
HD0950-09	STAINLESS STEEL	BRUSHED	SURFACE	110/120	1600	12.5	15 LBS.
HD0951-09	STAINLESS STEEL	BRUSHED	SURFACE	220/240	1600	8.5	25 LBS.



FRONT VIEW



SIDE VIEW



BACK MOUNTING VIEW

MODEL NO.	COVER MATERIAL	FINISH	MOUNTING OPTIONS	VOLTS	WATTS	AMPS
HD0955-09	STAINLESS STEEL	BRUSHED	RECESSED	110/120	1600	12.5
MEETS ADA REQUIREMENTS						





ON THE FRONT OF INNOVATION...



The BluStorm is GreenSpec® listed.

Products selected for the GreenSpec® list are considered to be the top of class and environmentally preferable, based on usgbc building green's criteria.

BluStorm can help earn leed credits based on ea credit 1 for optimized energy performance.

Power cuts off automatically in case of irregular use over 60 seconds

One piece cover with 2 vandal proof lock screws and key wrench

Blue light helps user to maximize efficiency

Manufactured from stainless steel

Thermally protected

Automatic on/off

Thermostat automatically turns unit off at 85° C

5 Year Warranty



Customizing your BluStorm is easy!  
Call us for details.

### OPTIONAL AIR FILTER ASSEMBLY

The high permanent electrostatic charge of the filters capture submicron particles that make up 99% of the air, helping to create a cleaner and more hygienic drying experience.



### FINANCIAL IMPACT

95% cost savings vs. paper towels

Over 70% cost savings vs. conventional hand dryers

Uses 80% less energy than conventional hand dryers

BluStorm costs .0004 cents per use\*

\*Cost per use is approximate and will vary depending upon kilowatt rate and length of use.

*Stop throwing your money away with paper towels*



**PALMER  
FIXTURE**

*Since 1907*

P.O. BOX 10887 • GREEN BAY, WI 54307

P: 800.558.8678 • P: 920.884.8698 • F: 920.884.8699

E: [INFO@PALMERFIXTURE.COM](mailto:INFO@PALMERFIXTURE.COM)

[WWW.PALMERFIXTURE.COM](http://WWW.PALMERFIXTURE.COM)

V.4.2013